

Date:

Stand No:

Plot No:

UPP INVENTORY FIELD DATA SHEET				Cruiser Names	
START DATE: _____		START TIME: _____		Last Name	First
STAND # / Plot #: _____ / _____		Plot Slope: _____			
Plot Aspect: _____		Plot Elevation: _____			
END DATE: _____		END TIME: _____			
GPS Datum/Projection Used: _____					
UTM Zone: _____					
GPS Latitude: _____		Deg°	Min'	. Sec"	
GPS Longitude: _____		Deg°	Min'	. Sec"	
GPS UTM (Easting): _____					
GPS UTM (Northing): _____					
Pre-Treatment: <input type="checkbox"/>		Treatment Site: <input type="checkbox"/>		Yrs After Treatment: _____	
Post-Treatment: <input type="checkbox"/>		Control Site: <input type="checkbox"/>			
Plot Center		1) S - N: <input type="checkbox"/>		2) E - W: <input type="checkbox"/>	
Photo Points		3) N - S: <input type="checkbox"/>		4) W - E: <input type="checkbox"/>	
		End Transect		5) N - S: <input type="checkbox"/>	
		Photo Points		6) W - E: <input type="checkbox"/>	
Daubenmire		1N: <input type="checkbox"/>		2N: <input type="checkbox"/>	
Photo Points		3N: <input type="checkbox"/>		4N: <input type="checkbox"/>	
		5N: <input type="checkbox"/>		6W: <input type="checkbox"/>	
		7W: <input type="checkbox"/>		8W: <input type="checkbox"/>	
		9W: <input type="checkbox"/>		10W: <input type="checkbox"/>	
PLOT NOTES: (Record Non-Native/Noxious Weeds and other Details about the entire plot to aid future crews).					

Daubenmire Plots: % Aerial & Ground Cover: Forbs, Grasses, Shrubs; Average Height; Presence of Scat, Moss/Lichen																
	% Aerial Cover of Each (Can be > 100%)			% Overstory Canopy Cover: Daubenmire Frame. Facing Plot Center	% Ground Cover of Each (Totals to 100%)				Average Height of Each (Ft.' In.)			Presence of Each (X= Yes or Blank = No)				
	Forbes	Grasses	Shrubs		Bare Mineral Soil	Rocky Material	Litter/Duff	Live Basal Vegetation	Forbes	Grasses	Shrubs	Moss on Soil	Lichen on Soil	Elk Pellets	Deer Pellets	Cow Pie
Plot 1																
# Species																
Plot 2																
# Species																
Plot 3																
# Species																
Plot 4																
# Species																
Plot 5																
# Species																
Plot 6																
# Species																
Plot 7																
# Species																
Plot 8																
# Species																
Plot 9																
# Species																
Plot 10																
# Species																

Date:

Stand No:

Plot No:

Seedlings/Saplings: 1/300th acre Plots. 6' 9.6" Radius (6.8' Radius). Located at 45' on each 75' transect.

Regen Plot 1 (North)				Regen Plot 2 (West)			
Seedlings		Saplings		Seedlings		Saplings	
Species	Count	Species	Count	Species	Count	Species	Count
Regen Plot 3 (South)				Regen Plot 4 (East)			
Seedlings		Saplings		Seedlings		Saplings	
Species	Count	Species	Count	Species	Count	Species	Count

SITE/Growth TREE: Pick 1 Dominant, Live, Healthy Tree on Plot.

Quadrant Number	Tree No.	Species	Total Height	Age @ DBH	Last 10-year Growth (1/20th inch)

OAK DATA: Choose an Average sized Oak on plot

Quadrant Number	DRC	HEIGHT	AGE	Appox. No. Oak in Plot

Date:

Stand No:

Plot No:

OVERSTORY INVENTORY (150' x 150' Plot): Inventory Live & Dead Standing Trees.																	
Tree No.	Species	DBH	CBH Class	Tree Status	Crown Class	Insect/Disease	Dist. N or S	Dist. E or W CLASS	Tree No.	Species	DBH	CBH Class	Tree Status	Crown Class	Insect/Disease	Dist. N or S	Dist. E or W CLASS
1									51								
2									52								
3									53								
4									54								
5									55								
6									56								
7									57								
8									58								
9									59								
10									60								
11									61								
12									62								
13									63								
14									64								
15									65								
16									66								
17									67								
18									68								
19									69								
20									70								
21									71								
22									72								
23									73								
24									74								
25									75								
26									76								
27									77								
28									78								
29									79								
30									80								
31									81								
32									82								
33									83								
34									84								
35									85								
36									86								
37									87								
38									88								
39									89								
40									90								
41									91								
42									92								
43									93								
44									94								
45									95								
46									96								
47									97								
48									98								
49									99								
50									100								

Date:

Stand No:

Plot No:

OVERSTORY INVENTORY (150' x 150' Plot): Inventory Live & Dead Standing Trees.

Tree No.	Species	DBH	CBH Class	Tree Status	Crown Class	Insect/ Disease	Dist. N or S	Dist. E or W Class	Tree No.	Species	DBH	CBH Class	Tree Status	Crown Class	Insect/ Disease	Dist. N or S	Dist. E or W Class
101									151								
102									152								
103									153								
104									154								
105									155								
106									156								
107									157								
108									158								
109									159								
110									160								
110									161								
112									162								
113									163								
114									164								
115									165								
116									166								
117									167								
118									168								
119									169								
120									170								
121									171								
122									172								
123									173								
124									174								
125									175								
126									176								
127									177								
128									178								
129									179								
130									180								
131									181								
132									182								
133									183								
134									184								
135									185								
136									186								
137									187								
138									188								
139									189								
140									190								
141									191								
142									192								
143									193								
144									194								
145									195								
146									196								
147									197								
148									198								
149									199								
150									200								

Date:

Stand No:

Plot No:

OVERSTORY INVENTORY (150' x 150' Plot): Inventory Live & Dead Standing Trees.

Tree No.	Species	DBH	CBH Class	Tree Status	Crown Class	Insect/ Disease	Dist. N or S	Dist. E or W CLASS	Tree No.	Species	DBH	CBH Class	Tree Status	Crown Class	Insect/ Disease	Dist. N or S	Dist. E or W CLASS
201									251								
202									252								
203									253								
204									254								
205									255								
206									256								
207									257								
208									258								
209									259								
210									260								
211									261								
212									262								
213									263								
214									264								
215									265								
216									266								
217									267								
218									268								
219									269								
220									270								
221									271								
222									272								
223									273								
224									274								
225									275								
226									276								
227									277								
228									278								
229									279								
230									280								
231									281								
232									282								
233									283								
234									284								
235									285								
236									286								
237									287								
238									288								
239									289								
240									290								
241									291								
242									292								
243									293								
244									294								
245									295								
246									296								
247									297								
248									298								
249									299								
250									300								

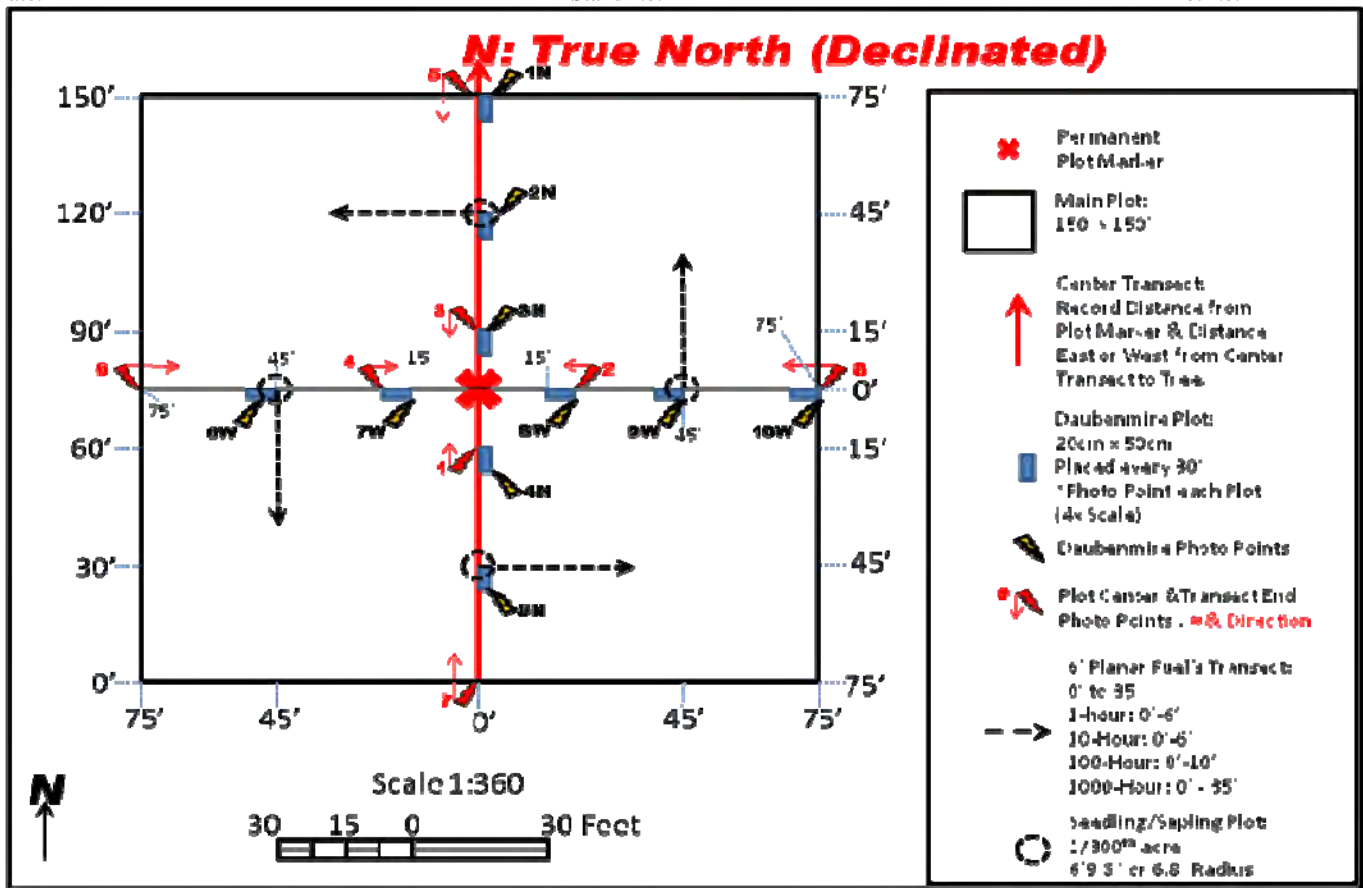

Tree Status	<u>L</u> : LIVE	<u>D</u> : DEAD	<u>S</u> : STUMP				
CROWN CLASS	<u>OG</u> : Open Grown	<u>DOM</u> : Dominant	<u>COD</u> : Co-Dominant	<u>INT</u> : Intermediate	<u>OT</u> : Over Topped		
Crown Base Height	0' - 6'	6' - 10'	10' - 15'	15' - 20'	> 20'		
CBH Class	1	2	3	4	5		
East/West Distance	0' - 10'	10' - 20'	20' - 30'	30' - 40'	40' - 50'	50' - 60'	60' - 75'
East/West Distance Class	1	2	3	4	5	6	7

Insect/Disease/Damage	Code	Insect/Disease/Damage	Code
Dwarf Mistle Toe	DMT	Aspen Conk	AC
Mountain Pine Beetle	MPB	Aspen Rot	AR
Ips Beetle	IPS	Animal Damage	AND
Spruce Beetle	SB		
Doug-Fir Beetle	DFB		
Spruce Bud Worm	SBW		

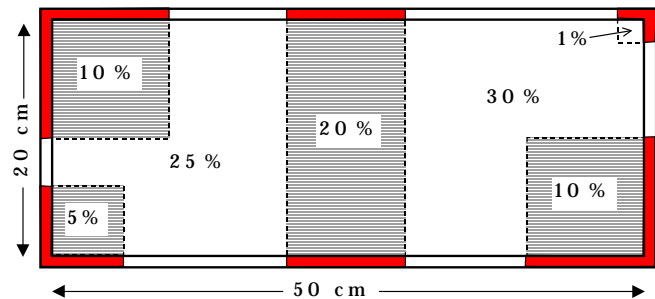

CD	RANGE	MID	CD	RANGE	MID
T	0-1%	0.5%	5	45-55%	50%
0	1-5%	3%	6	55-65%	60%
1	5-15%	10%	7	65-75%	70%
2	15-25%	20%	8	75-85%	80%
3	25-35%	30%	9	85-95%	90%
4	35-45%	40%	A	95-99%	97%
			X	99-100%	99.5%